

GIS-CH ELECTRIC CHAIN HOIST: SIMPLE, RELIABLE, SECURE.



GIS® Lifting and Crane Technology
Faith in technology. Faith in GIS.

GIS-CHAIN HOIST



- Compact design
- Robust construction
- Ease of maintenance
- Availability assured
- Advanced technology
- Swiss quality
- Outstanding service life
- Maximum safety

GIS-CH ELECTRIC CHAIN HOIST:

type	lifting capacity kg					lifting speed m/min	chain
	1Bm M3	1Am M4	2m M5	3m M6	4m M7		
GCH 250/1N	250	200	160	125	100	8	4x12.3
GCH 250/1NF	250	200	160	125	100	8/2	4x12.3
GCH 250/1SF	160	125	100	80	60	12.5/3	4x12.3
GCH 250/1HF	100	80	60	50	40	20/5	4x12.3
GCH 250/2N	500	400	320	250	200	4	4x12.3
GCH 250/2NF	500	400	320	250	200	4/1	4x12.3
GCH250/2SF	320	250	200	160	125	6.3/1.5	4x12.3
GCH 500/1N	500	400	320	250	200	8	5x15.3
GCH 500/1NF	500	400	320	250	200	8/2	5x15.3
GCH 500/1SF	320	250	200	160	125	12.5/3	5x15.3
GCH 500/1HF	200	160	125	100	80	20/5	4x12.3
GCH 500/2N	1000	800	630	500	400	4	5x15.3
GCH 500/2NF	1000	800	630	500	400	4/1	5x15.3
GCH 500/2SF	630	500	400	320	250	6.3/1.5	5x15.3

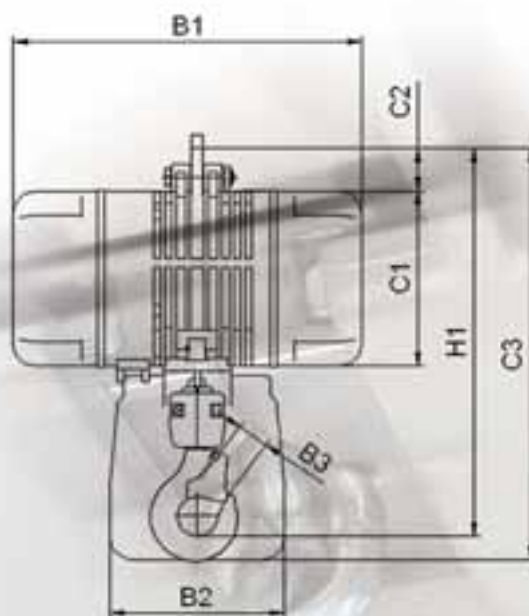
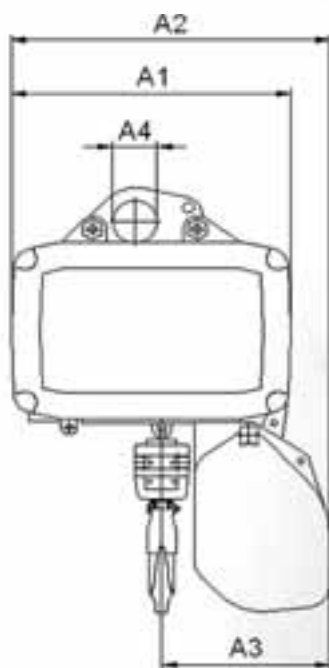

A1 = 248 mm
A2 = 282 mm
A3 = 150 mm

A4 = 40 mm
B1 = 309 mm
B2 = 155 mm

B3 = 22 mm
C1 = 164 mm
C2 = 40 mm
C3 = 385 mm

H1 = 363 mm

Accessories and versions of GIS-CH electric chain hoist

- Hook suspension
- Push travel trolley
- Electric travel trolley
- Electric travel trolley controlled by frequency inverter
- Low head room version for low ceilings
- Synchronized electric chain hoist for large and wide goods
- Handy chain and telescope models for precise and easy positioning
- Corrosion resistant electric chain hoist
- Electric chain hoist for theatres, stages and studios

..... more information under www.gis-ag.ch

Brake

- Maximum safety (construction: brake after slipping clutch)
- New advanced brake design
- Unique availability
- Maintenance free



Chain wheel

- Made of hardened steel
- With additional chain pockets (4mm): hence quiet running and improved running properties
- With double bearing construction



Geared limit switch (standard)

- Simple adjustment
- Exact positioning
- Lifting heights up to 120 m
- Accuracy for repetition assured

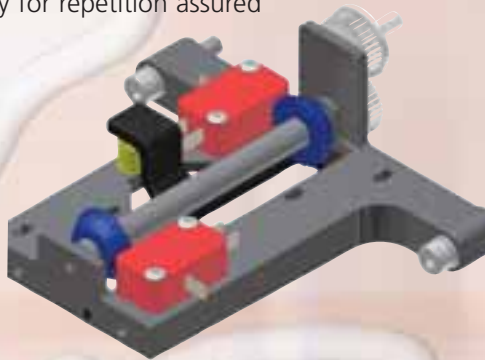

Transmission

- Helical-toothed first and second gear step for quiet running
- Permanent lubrication for wear resistant operation



Contactors control system

- Simple technology (no electronics susceptible to interference)
- Reliable technique
- Emergency stop as a standard
- 42V control system allowing highest safety of operation

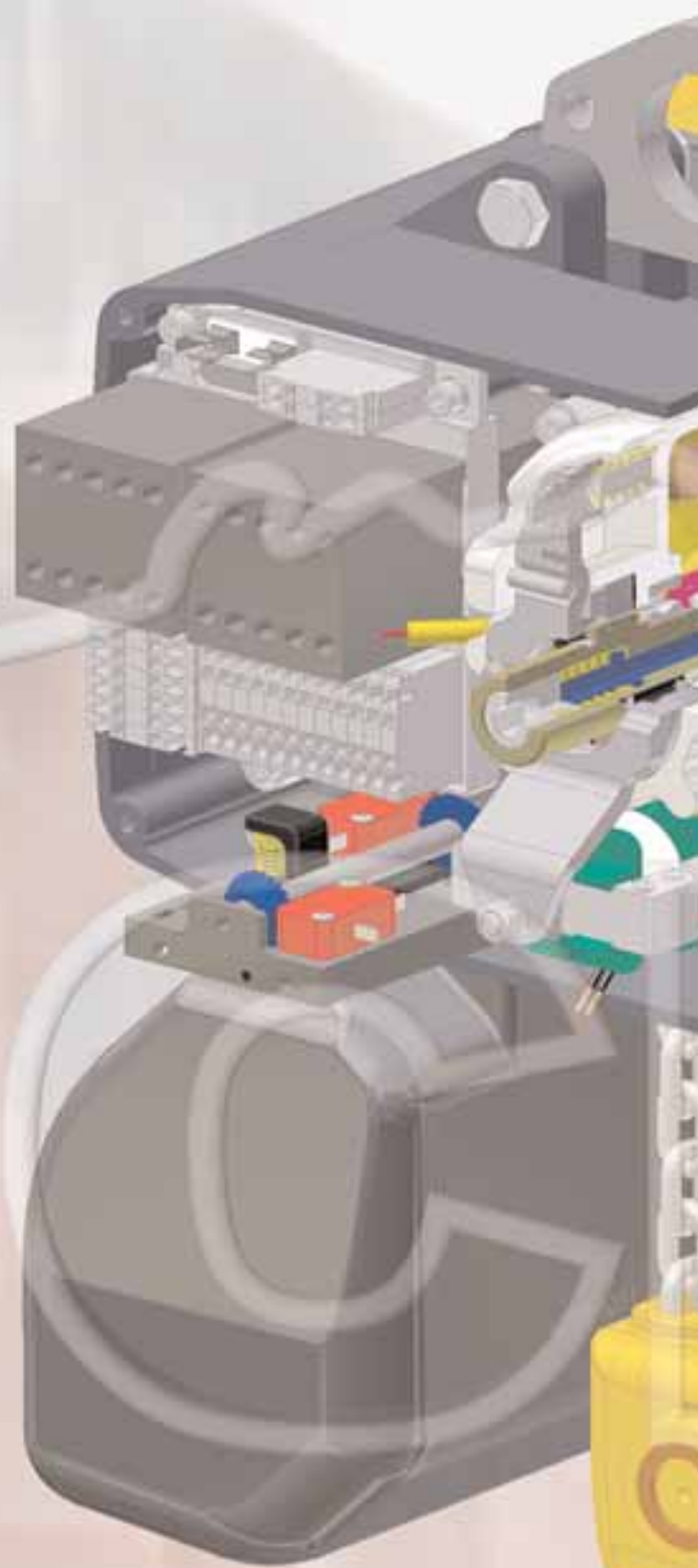

Hoisting chain

- Calibrated especially for GIS
- Zinc plated
- Surface-hardened
- Quality class DAT (8SS) to FEM 9.671



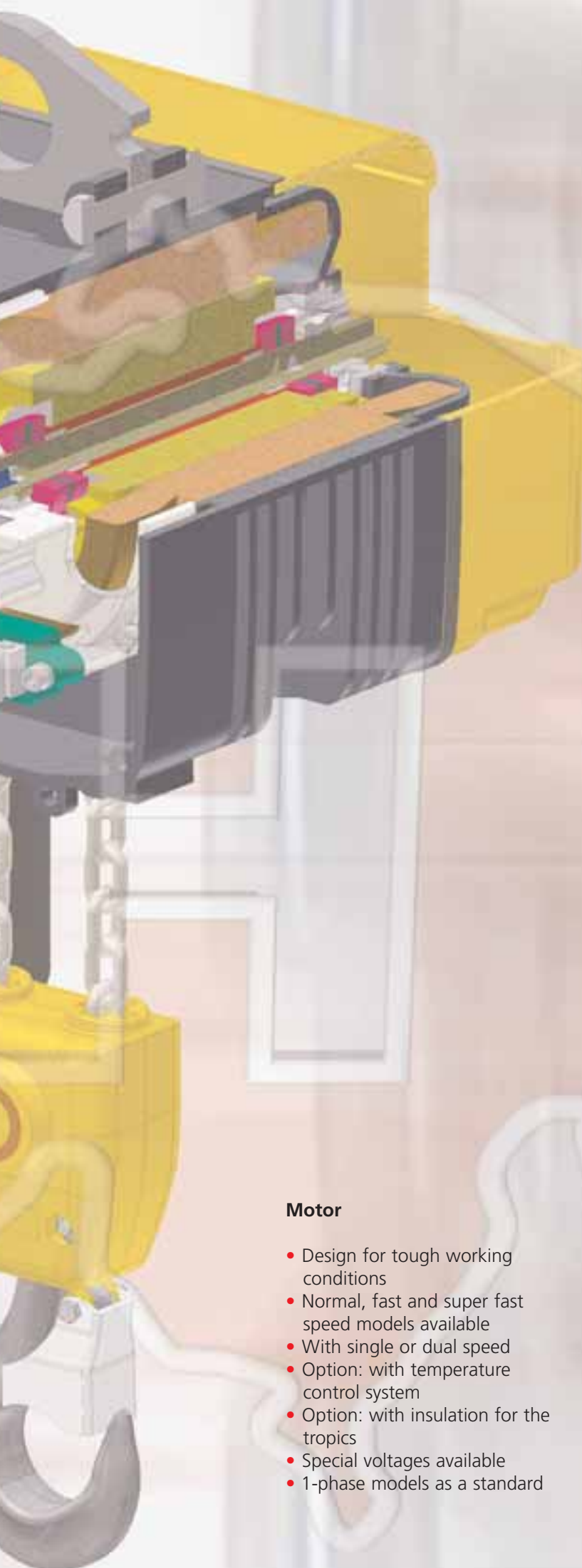

Chain guidance

- 2-part construction to optimize maintenance
- Reinforced plastic material highly wear resistant
- Safe operation: jamming excluded



Slipping clutch

- Simple and precise adjustment
- Maintenance free and highly resistant to wear
- Ease of servicing thanks to comfortable access



Control switch

- With built-in support wire as a standard
- 2-buttons: design especially ergonomic
- Emergency stop as a standard
- Protection: IP65 to DIN 40050



Motor

- Design for tough working conditions
- Normal, fast and super fast speed models available
- With single or dual speed
- Option: with temperature control system
- Option: with insulation for the tropics
- Special voltages available
- 1-phase models as a standard

Housing

- Cast aluminium housing with maximum solidity (no plastic material)
- For extreme working conditions: casted cooling gills
- Easy transformation from 1-fall to 2-falls operation: no need of dismantling



Lifting technology
Crane technology
Vacuum lifting technology

FAITH IN TECHNOLOGY.
FAITH IN GIS.

GIS customer expectations

Check of requirements
Situation analysis
Standard specifications
Objectives



GIS concept

Goods handling concept
Advice on solutions
Concept
Budgeting/offer



GIS implementation

Implementation
Planning
Delivery
Commissioning/
installation



Productive solutions

Optimised costs

After-sales service

Long-term guarantee

You will find our representatives in more than 40 countries and detailed technical documentation at

www.gis-ag.ch

GIS AG

Hebe- und Fördertechnik
Luzernerstrasse 50
CH-6247 Schötz

Phone +41 (0)41 980 00 71

Fax +41 (0)41 980 16 06

tel@gis-ag.ch

www.gis-ag.ch

Certified to ISO 9001

 **Lifting and Crane Technology**
Faith in technology. Faith in GIS.

EHF 50/150

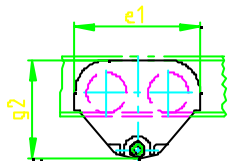

EHF 300/500

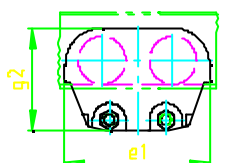

EHF 50/150/300/500

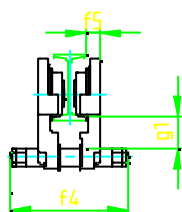

EMFE 50/150

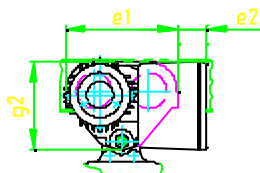

EMFE 300/500

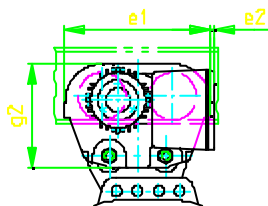

EMFE 50/150/300/500

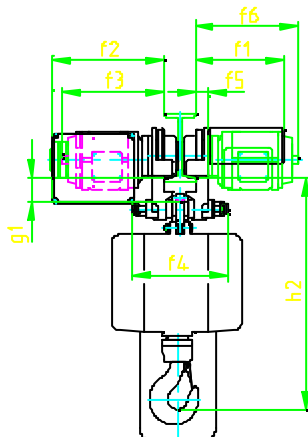

**Push carriages (EHF) and electric carriages (EMFE)
500 - 5000 kg**

Specification

FEM classification	1Bm 150 s/h 25% duty	1Am 180 s/h 30% duty	2m 240 s/h 40% duty	3m 300 s/h 50% duty	4m 360 s/h 60% duty	Travelling speed	Motor power	For 3x380/420 V 50 Hz	Dead weight
Types	Capacity [kg]					[m/min]	[kW]	[A]	[kg]
EHF 50	1'000	800	630	630	500	-	-	-	7.5
EMFE 50/N	1'000	800	630	630	500	12	0.25	0.8	27
EMFE 50/NF	1'000	800	630	630	500	12/4	0.15/0.045	0.65/0.75	27
EMFE 50/SF	800	800	630	630	500	20/6	0.15/0.045	0.65/0.75	27
EHF 150	2'000	2'000	1'600	1'600	1'250	-	-	-	13.5
EMFE 150/N	2'000	2'000	1'600	1'600	1'250	12	0.25	0.8	31
EMFE 150/NF	2'000	2'000	1'600	1'600	1'250	12/4	0.15/0.045	0.65/0.75	31
EMFE 150/SF	1'600	1'600	1'600	1'600	1'250	20/6	0.15/0.045	0.65/0.75	31
EHF 300	4'000	4'000	3'200	2'500	2'500	-	-	-	27.5
EMFE 300/N	4'000	4'000	3'200	2'500	2'500	12	0.25	0.8	50
EMFE 300/NF	4'000	4'000	3'200	2'500	2'500	12/4	0.15/0.045	0.65/0.75	50
EMFE 300/SF	3'200	3'200	3'200	2'500	2'500	20/6	0.15/0.045	0.65/0.75	50
EHF 500	5'000	4'000	3'200	3'200	2'500	-	-	-	27.5
EMFE 500/N	5'000	4'000	3'200	3'200	2'500	12	2x0.25	2x0.8	57
EMFE 500/NF	5'000	4'000	3'200	3'200	2'500	12/4	2x0.15/0.045	2x0.65/0.75	57
EMFE 500/SF	4'000	4'000	3'200	3'200	2'500	20/6	2x0.15/0.045	2x0.65/0.75	57

Dimensions

Types	e1 [mm]	e2 [mm]	f1 [mm]	f2 [mm]	f3 [mm]	f4 [mm]	f5 [mm]	f6 [mm]
EHF 50	215	-	-	-	-	183	24	-
EMFE 50	215	56	210	268	240	183	24	-
EHF 150	250	-	-	-	-	230	27	-
EMFE 150	250	39	212	270	242	230	27	-
EHF 300	312	-	-	-	-	290	33	-
EMFE 300	312	8	217	275	247	290	33	-
EHF 500	312	-	-	-	-	290	33	-
EMFE 500	312	8	-	275	247	290	33	247

Types	g1 [mm]	g2 [mm]	h2 [mm]				Flange width [mm]
			EM 25/1	EM 25/2	EM 50/1	EM 50/2	
EHF 50	49	167	445	449	460	461	50 - 99
EMFE 50	49	167	445	449	460	461	50 - 99
			EM 100/1	EM 100/2	EM 150/1	EM 150/2	
EHF 150	59	203	544	619	554	629	76 - 139
EMFE 150	59	203	544	619	554	629	76 - 139
			EM 200/1	EM 200/2	EM 300/1	EM 300/2	
EHF 300	55	218	582	701	586	708	120 - 179
EMFE 300	55	218	582	701	586	708	120 - 179
			EM 500/1	EM 500/2			
EHF 500	55	218	586	708	-	-	120-179
EMFE 500	55	218	586	708	-	-	120-179

Options: other flange widths
Electric carriage with brake

Standard voltages: 3Ph 380/400 V, 50 Hz; 3Ph 220/230 V, 50 Hz; 3Ph 415/420 V, 50 Hz

Special voltages: on request

Selection of carriages: EM 25/50: EHF/EMFE 50 EM 200/300: EHF/EMFE 300
EM 100/150: EHF/EMFE 150 EM 500: EHF/EMFE 500

GIS AG
Hebe- und Fördertechnik
Luzernerstrasse 50
CH-6247 Schötz
Telefon 041 / 980 00 71 Fax 041 / 980 16 06
www.gis-ag.ch

Pfaff-silberblau Ltd
Prenton Way, North Cheshire Trading Estate
Prenton, Wirral, CH43 3DU
Tel: +44(0) 151 609 0099
Fax: +44(0) 151 609 0852
Email: anyone@pfaff.u-net.com
www.pfaff-silberblau.co.uk